

MiCRO

Cilindros Inoxidables ISO 15552

Serie AMX Diam 32 a 200 mm

| | |
|----------------------------|--|
| Tipo | Cilindros doble efecto de acero inoxidable 316L, con imán incorporado en el pistón. Con amortiguación neumática ajustable. |
| Normas | ISO 15552. |
| Sellos | Serie V ... FMK Serie V1 ... Solo sello de trompa FMK Serie BT ... Sellos baja temperatura. |
| Temperatura ambiente | -20 ° C a +80 ° C (estándar / V1) -20 ° C a + 150 ° C (V) -40 ° C a + 80 ° C (BT) |
| Fluido | Aire comprimido filtrado con o sin lubricar. |
| Presion de trabajo | 0,5 a 10 bar. |



Codificación

| Ø | Descripcion | Codigo |
|-----|---|-------------------|
| 32 | CIL. ISO15552 FULL INOX. AISI316 D32 2E 2A I SELLO VITON | 2.087.26X.XXX.504 |
| 40 | CIL. ISO15552 FULL INOX. AISI316 D40 2E 2A I SELLO VITON | 2.088.26X.XXX.504 |
| 50 | CIL. ISO15552 FULL INOX. AISI316 D50 2E 2A I SELLO VITON | 2.089.26X.XXX.504 |
| 63 | CIL. ISO15552 FULL INOX. AISI316 D63 2E 2A I SELLO VITON | 2.090.26X.XXX.504 |
| 80 | CIL. ISO15552 FULL INOX. AISI316 D80 2E 2A I SELLO VITON | 2.091.26X.XXX.504 |
| 100 | CIL. ISO15552 FULL INOX. AISI316 D100 2E 2A I SELLO VITON | 2.092.26X.XXX.504 |
| 125 | CIL. ISO15552 FULL INOX. AISI316 D125 2E 2A I SELLO VITON | 2.093X26X.XXX.504 |
| 160 | CIL. ISO15552 FULL INOX. AISI316 D160 2E 2A I SELLO VITON | 2.094.26X.XXX.504 |
| 200 | CIL. ISO15552 FULL INOX. AISI316 D200 2E 2A I SELLO VITON | 2.095.26X.XXX.504 |

Reemplazar XXXX por carrera cilindro

Materiales

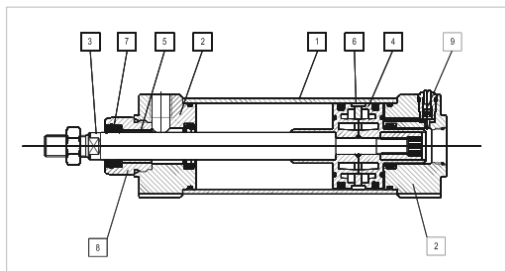

| Materiales (serie estándar) | | |
|------------------------------|---------------------------|-------------------------------------|
| 1 | Camisa y tensores | Acero inoxidable AISI 316L |
| 2 | Tapas delantera y trasera | Acero inoxidable AISI 316L |
| 3 | Vastago | Acero inoxidable AISI 316L |
| 4 | Piston | Aluminio fundido a presión |
| 5 | Anillo de trompa | Bronce sinterizado autolubricante |
| 6 | Anillo Guia | Delrin Natural |
| 7 | Sellos de trompa | Poliuretano especial |
| 8 | Desensamblable de nariz | Acero inoxidable AISI 316L |
| 9 | Tornillo de amortiguacion | Acero inoxidable AISI 316L |
| | Otros sellos | Caucho de nitrilo NBR / poliuretano |

MiCRO

Cilindros Inoxidables ISO 15552

Serie AMX Diam 32 a 200 mm

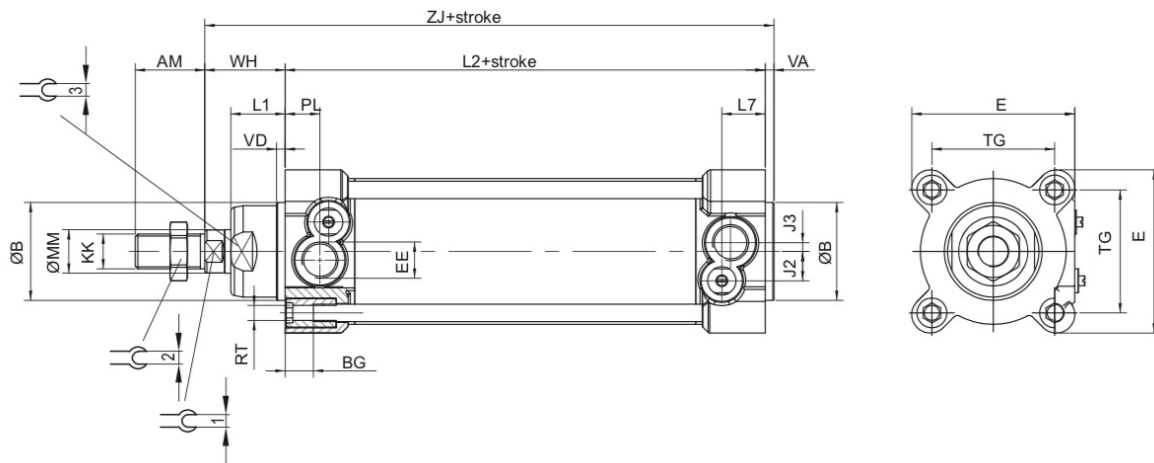

| Ø (mm) | AM | B Ø d11 | BG | E | EE | J2 | J3 | KK | L1 | L2 | H |
|--------|----|---------|----|-----|-------|------|-----|------------|----|-----|----|
| 32 | 22 | 30 | 15 | 47 | G 1/8 | 6 | 5 | M10 X 1,25 | 20 | 94 | 8 |
| 40 | 24 | 35 | 15 | 52 | G 1/4 | 7,5 | 5 | M12 X 1,25 | 22 | 105 | 6 |
| 50 | 32 | 40 | 16 | 65 | G 1/4 | 9,5 | 7,5 | M16 X 1,5 | 26 | 106 | 8 |
| 63 | 32 | 45 | 16 | 75 | G 3/8 | 13,5 | 4 | M16 X 1,5 | 25 | 121 | 8 |
| 80 | 40 | 45 | 17 | 95 | G 3/8 | 13,5 | 6 | M20 X 1,5 | 32 | 128 | 10 |
| 100 | 40 | 55 | 17 | 115 | G 1/2 | 15 | 6 | M20 X 1,5 | 38 | 138 | 10 |
| 125 | 54 | 60 | 21 | 140 | G 1/2 | 17 | 8 | M27 X 2 | 40 | 160 | 14 |
| 160 | 72 | 65 | 24 | 180 | G 3/4 | 17 | 15 | M36 X 2 | 50 | 180 | 14 |
| 200 | 72 | 75 | 24 | 220 | G 3/4 | 17 | 15 | M36 X 2 | 65 | 180 | 14 |

| Ø (mm) | L7 | MM Ø f7 | PL | RT | TG | VA | VD | WH | ZJ | 1 | 2 | 3 |
|--------|------|---------|------|-----|------|----|----|----|-----|----|----|----|
| 32 | 17,5 | 12 | 10 | M6 | 32 | 4 | 4 | 26 | 124 | 10 | 17 | 27 |
| 40 | 21,5 | 16 | 15 | M6 | 38 | 4 | 4 | 30 | 139 | 13 | 19 | 32 |
| 50 | 20 | 20 | 15 | M8 | 46,5 | 4 | 4 | 37 | 147 | 17 | 24 | 36 |
| 63 | 20 | 20 | 16 | M10 | 56,5 | 4 | 4 | 37 | 162 | 17 | 24 | 38 |
| 80 | 27 | 25 | 20 | M10 | 72 | 4 | 4 | 46 | 178 | 22 | 30 | 42 |
| 100 | 28,5 | 25 | 23,5 | M12 | 89 | 4 | 4 | 51 | 193 | 22 | 30 | 50 |
| 125 | 31,5 | 32 | 23,5 | M12 | 110 | 5 | 5 | 65 | 230 | 27 | 41 | 52 |
| 160 | 33 | 40 | 27,5 | M16 | 140 | 6 | 8 | 80 | 266 | 36 | 55 | 60 |
| 200 | 35 | 40 | 27 | M16 | 175 | 6 | 8 | 95 | 281 | 36 | 55 | 70 |

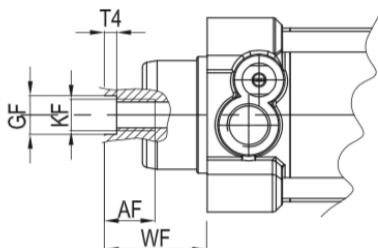
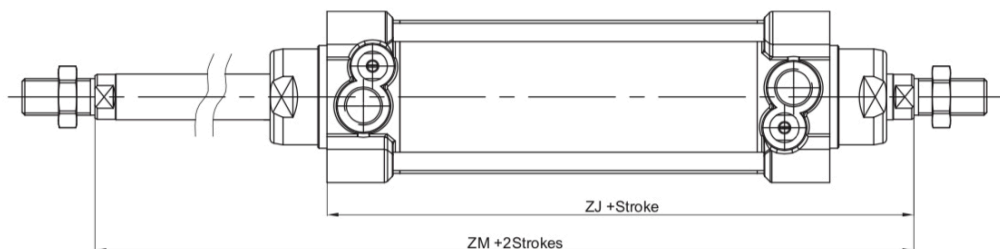
MiCRO**Cilindros Inoxidables
ISO 15552****Serie AMX
Diam 32 a 200 mm**

| \varnothing (mm) | AF | KF | T4 | WF | GF | ZJ | ZM |
|--------------------|----|-----|-----|----|----|-----|-----|
| 32 | 12 | M6 | 2,6 | 26 | 8 | 120 | 146 |
| 40 | 12 | M8 | 3,3 | 30 | 10 | 135 | 165 |
| 50 | 16 | M10 | 4,7 | 37 | 12 | 143 | 180 |
| 63 | 16 | M10 | 4,7 | 37 | 12 | 158 | 195 |
| 80 | 20 | M12 | 6,1 | 46 | 14 | 174 | 220 |
| 100 | 20 | M12 | 6,1 | 51 | 14 | 189 | 240 |
| 125 | 32 | M16 | 8 | 65 | 18 | 225 | 290 |
| 160 | 36 | M20 | 10 | 80 | 22 | 260 | 340 |
| 200 | 36 | M20 | 10 | 95 | 22 | 275 | 370 |

Serie TA1

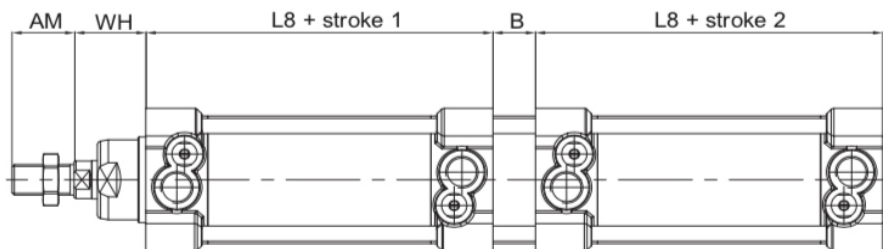

Serie TA2

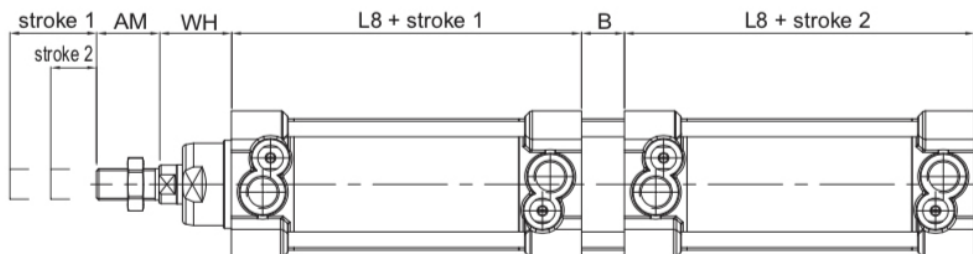

Serie TA3

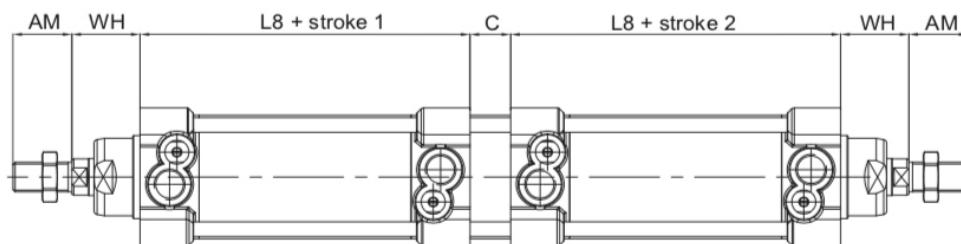

Serie TA4

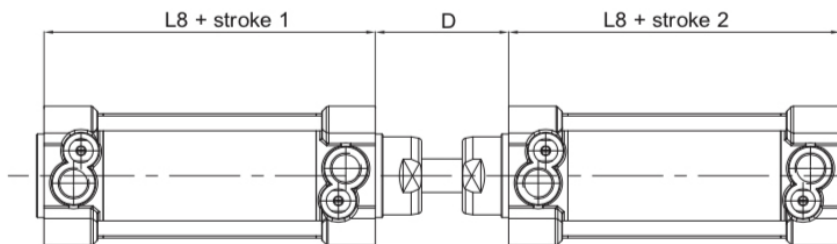

| ∅ (mm) | AM | B | C | D | L8 | WH |
|--------|----|-----|----|-----|-----|----|
| 32 | 22 | 40 | 12 | 48 | 94 | 26 |
| 40 | 24 | 44 | 12 | 54 | 105 | 30 |
| 50 | 32 | 52 | 16 | 69 | 106 | 37 |
| 63 | 32 | 50 | 16 | 69 | 121 | 37 |
| 80 | 40 | 64 | 20 | 83 | 128 | 46 |
| 100 | 40 | 76 | 20 | 91 | 138 | 51 |
| 125 | 54 | 80 | 35 | 120 | 160 | 65 |
| 160 | 72 | 100 | 50 | 152 | 180 | 80 |
| 200 | 72 | 130 | 50 | 167 | 180 | 95 |

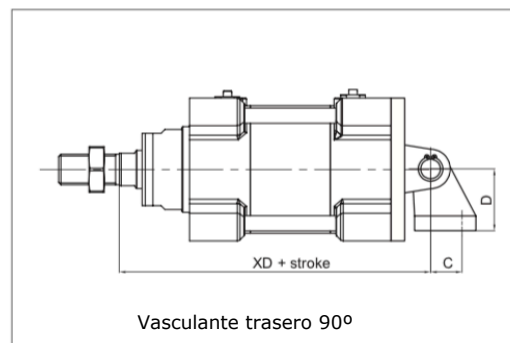
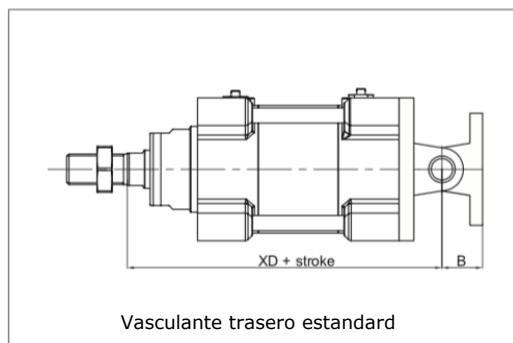
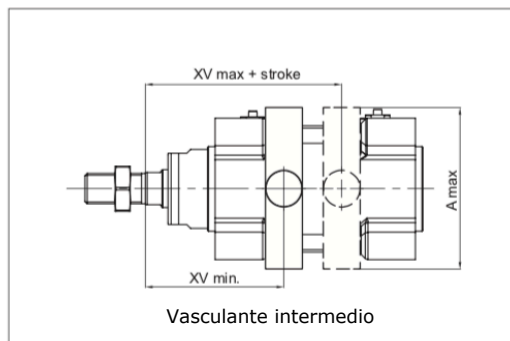
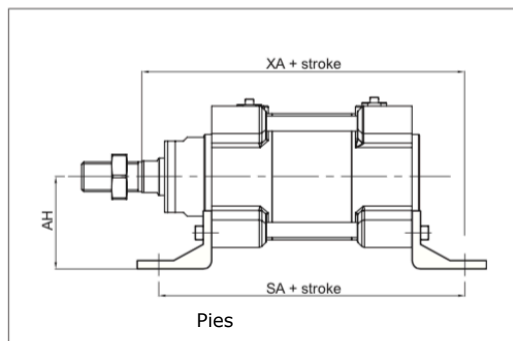
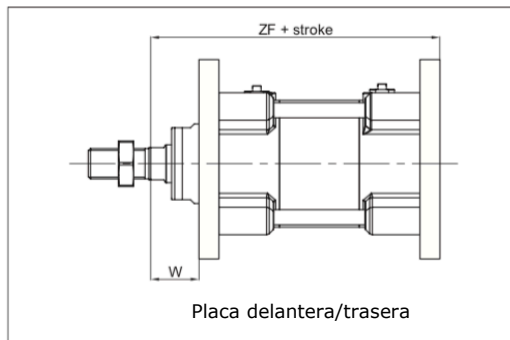
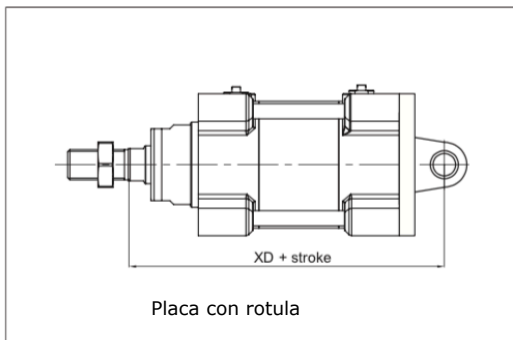

| ∅ (mm) | A max | AH | B | C | D | SA | W | XA | XD | XV min | XV max | ZF |
|--------|-------|-----|----|----|----|-----|----|-------|-----|--------|--------|-----|
| 32 | 70 | 32 | 22 | 21 | 32 | 142 | 16 | 144 | 142 | 60 | 86 | 130 |
| 40 | 78 | 36 | 25 | 24 | 36 | 161 | 20 | 163 | 160 | 69 | 96 | 145 |
| 50 | 91 | 45 | 27 | 33 | 45 | 170 | 25 | 175 | 170 | 78 | 102 | 155 |
| 63 | 94 | 50 | 32 | 37 | 50 | 185 | 25 | 190 | 190 | 82 | 113 | 170 |
| 80 | 130 | 63 | 36 | 47 | 63 | 210 | 30 | 215 | 210 | 97 | 123 | 190 |
| 100 | 145 | 71 | 41 | 55 | 71 | 220 | 35 | 230 | 230 | 107 | 133 | 205 |
| 125 | 170 | 90 | 50 | 70 | 90 | 250 | 45 | 270 | 275 | 126,5 | 163,5 | 245 |
| 160 | 190 | 115 | 55 | / | / | 300 | 55 | 305 | 315 | 150 | 190 | 285 |
| 200 | 240 | 135 | 60 | / | / | 320 | 70 | 322,5 | 335 | 165 | 205 | 300 |